



Proposed Modified Development Plan

Substantially similar to the 2006 Approved Development Plan

	2006	April 2009
	Approved	Proposed
	Development Plan	Modified Plan

INTERIM

Gaming Floor SF	40,400	40,000
No. of Slots	1,500	1,700
F&B Outlets	3	3
Parking Spaces *	2,700	1,465
Cage SF	6,700	5,000
PSP / PGCB SF	2,650	2,800

PHASE 1

Gaming Floor SF	84,000	80,000
No. of Slots	3,000	3,000
F&B Outlets	8	7
Parking Spaces	3,063	3,265
Cage SF	6,700	5,000
PSP / PGCB SF	2,650	2,800

* Construction of a 2,400 space parking garage was planned during the interim phase under the Approved Development Plan. Under the Proposed Modified Plan, during the interim phase approximately 1,465 parking spaces will be provided on surface lots and a 3,300 space parking garage will be constructed after the opening of the interim facility.

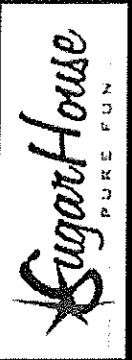

Interim Casino Comparison

A Permanent and Core Facility

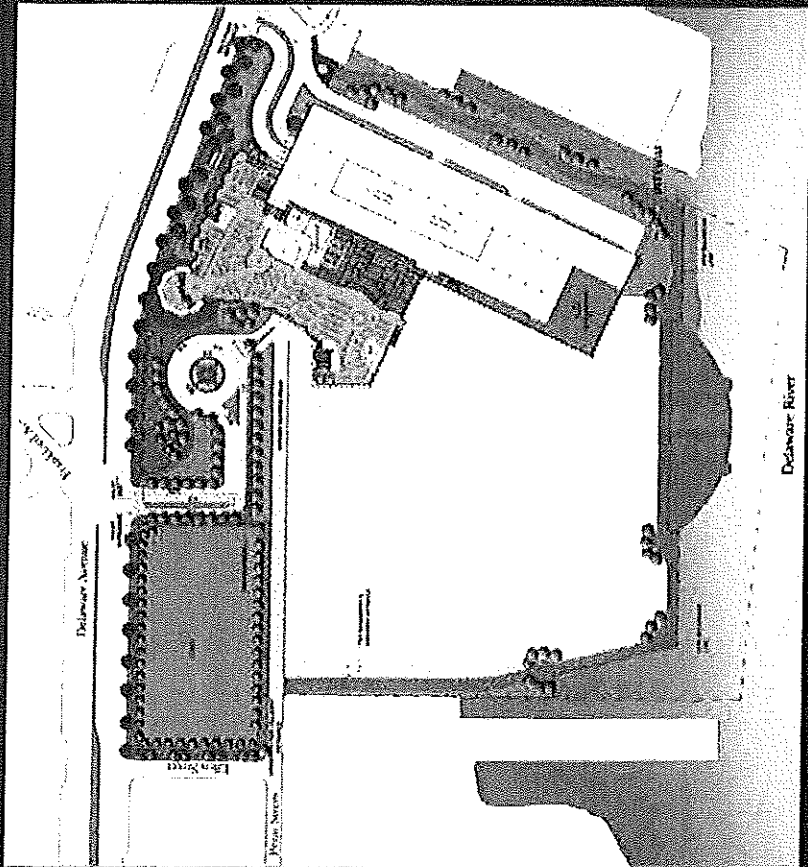

November 2006 Plan
+/- 1,500 slots

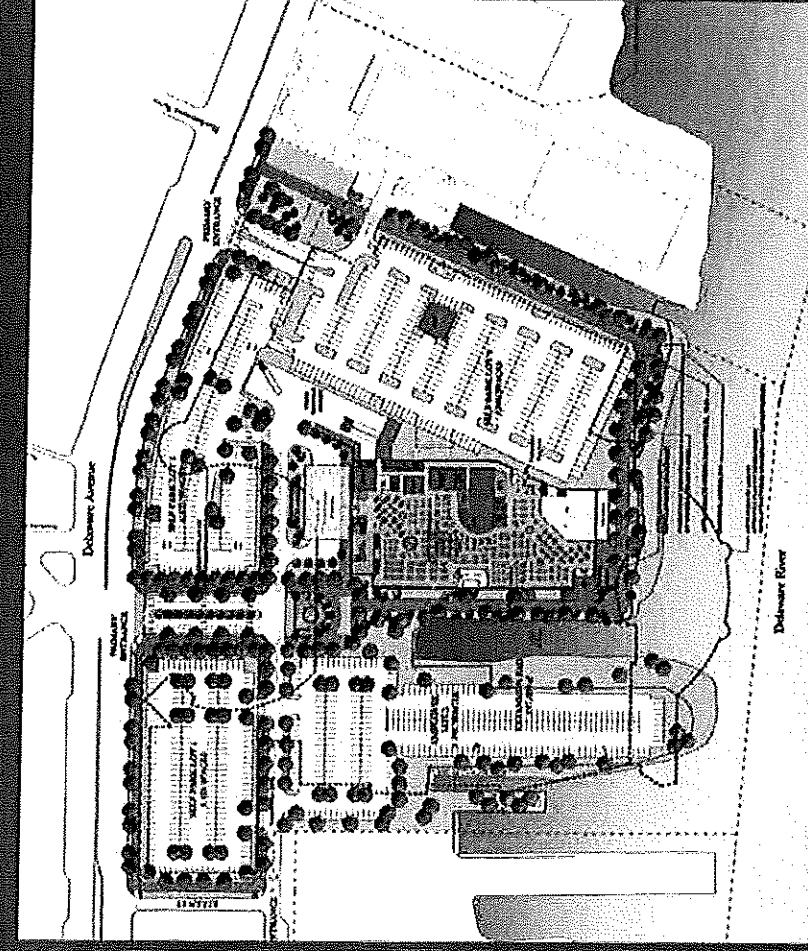

April 2009 Plan
+/- 1,700 slots

Images courtesy of Cope Linder Architects



Interim Casino Comparison

A Permanent and Core Facility

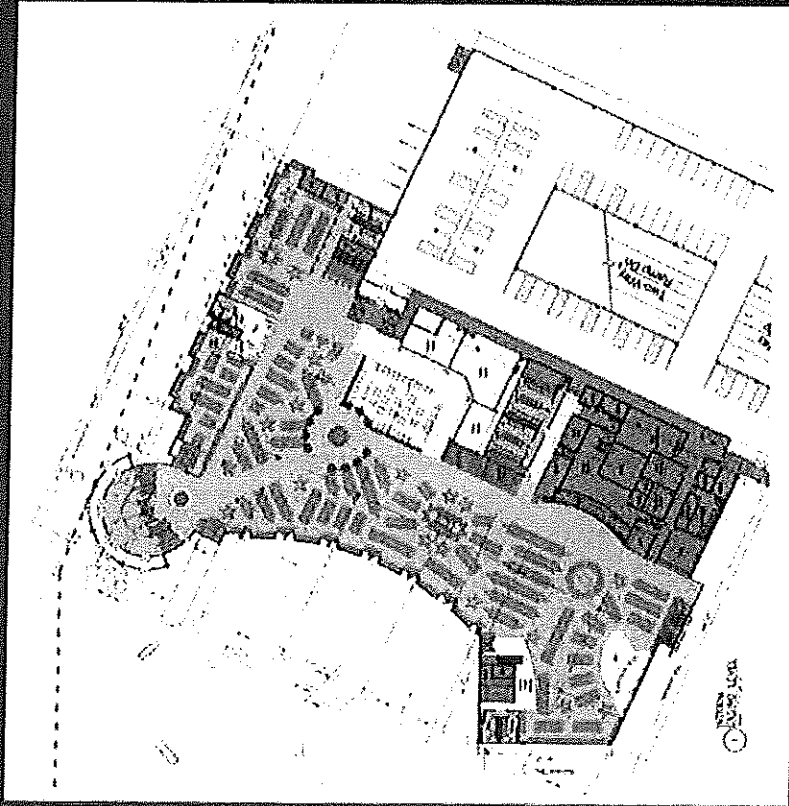

November 2006 Plan

+/- 1,500 slots

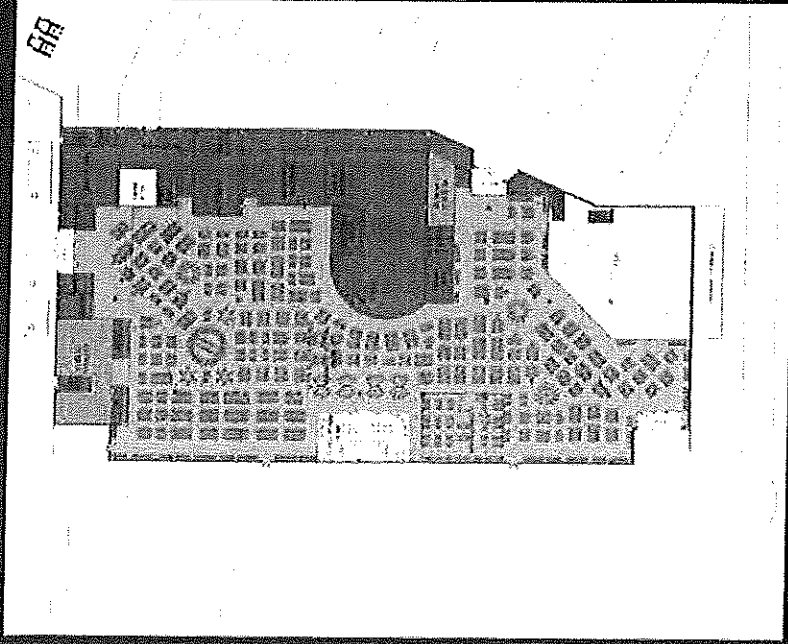

April 2009 Plan

+/- 1,700 slots

SugarHouse
PURE FUN

Images courtesy of Cope Linder Architects

★ Phase One Comparison

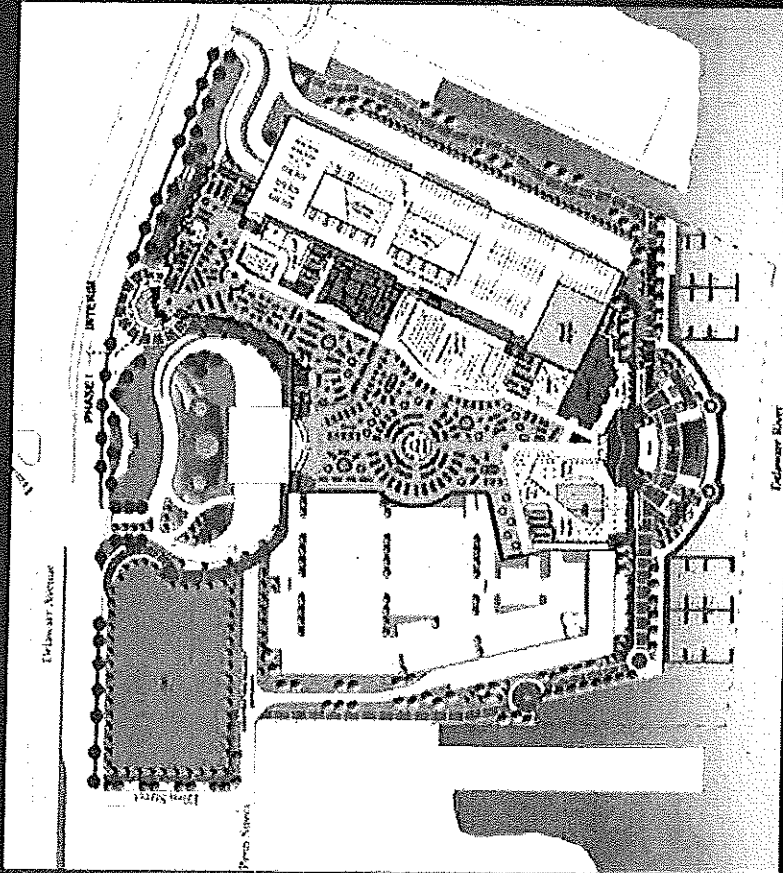

November 2006 Plan

+/- 3,000 slots

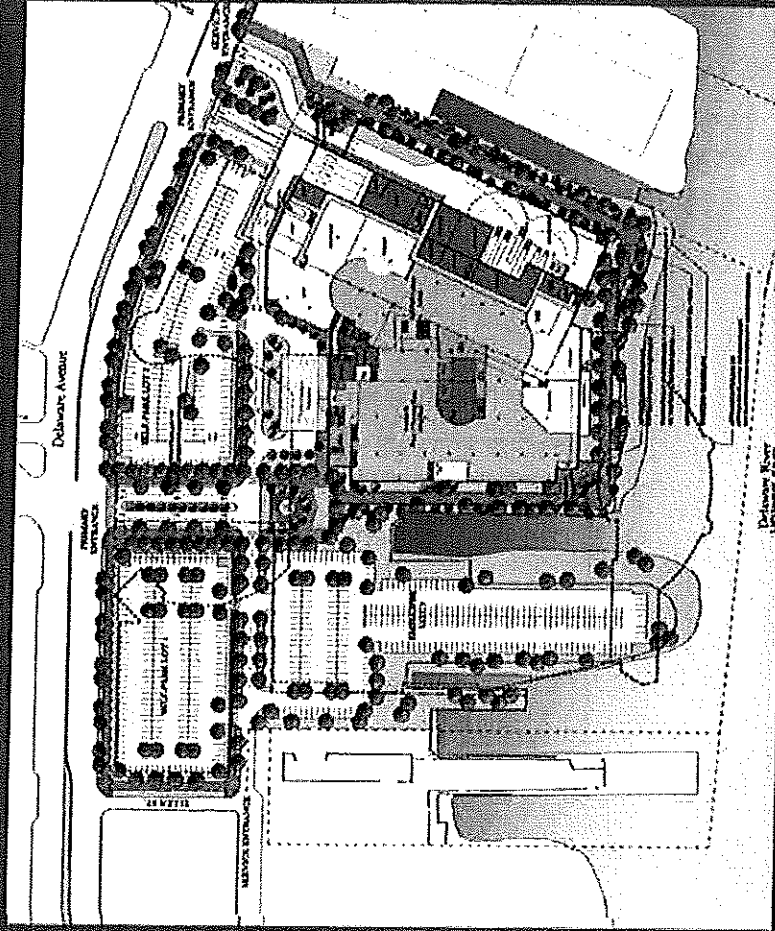

April 2009 Plan

+/- 3,000 slots



Images courtesy of Cope Linder Architects

★ Phase Two / Future Development Comparison

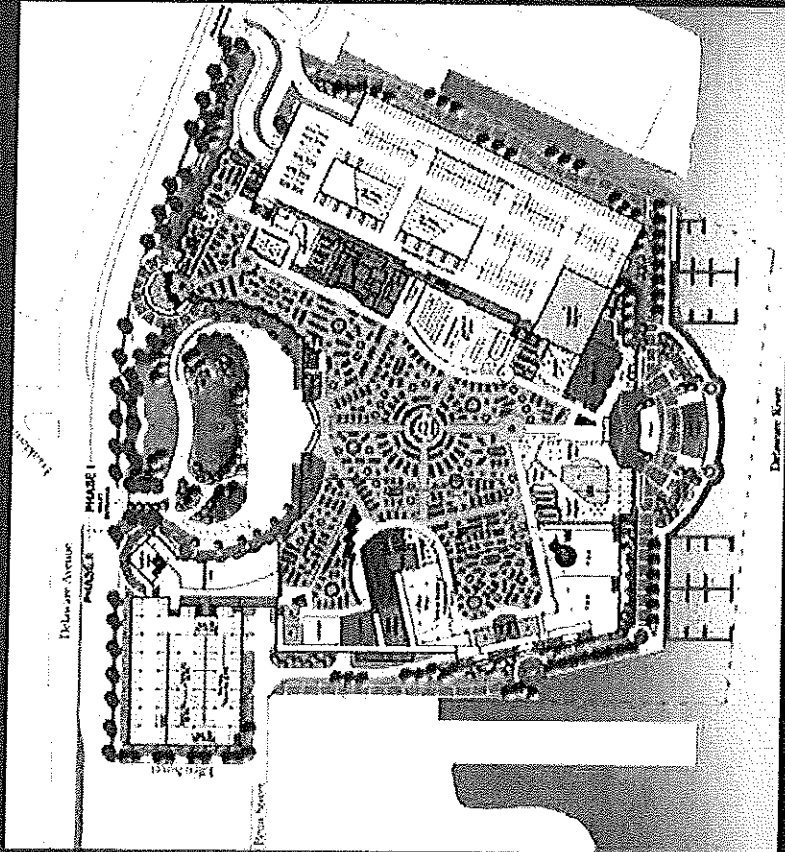

November 2006 Plan

→ ~ 5,000 slots

Potential Hotel(s) & Addl. Structured Parking

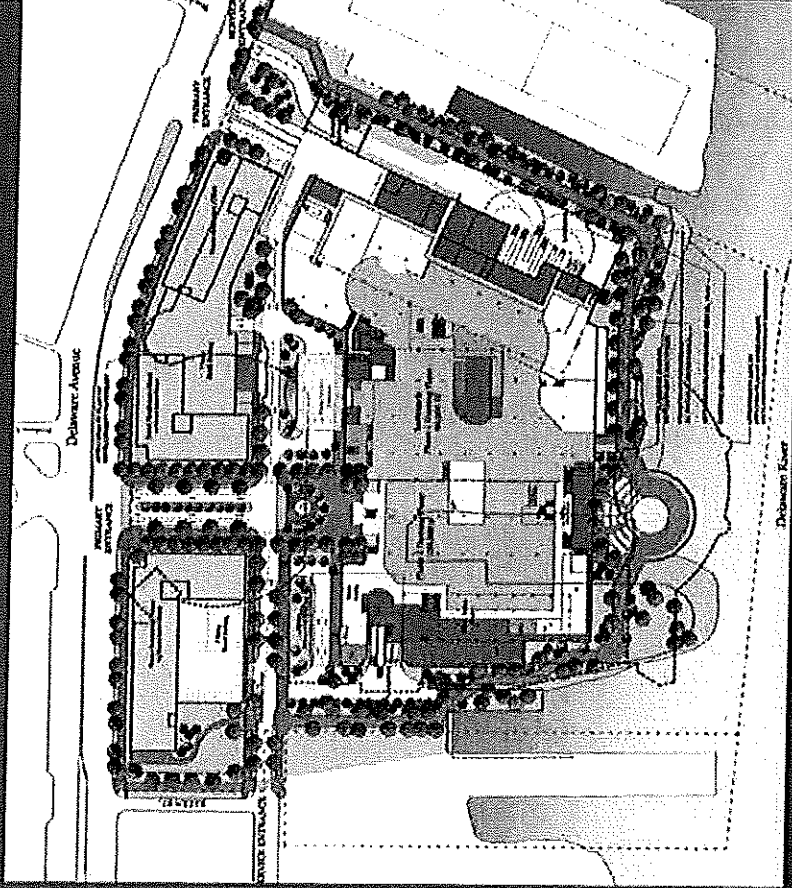

April 2009 Plan

→ ~ 5,000 slots

Potential Hotel(s) & Addl. Structured Parking



Images courtesy of Cope Linder Architects

SugarHouse

PURE FUN

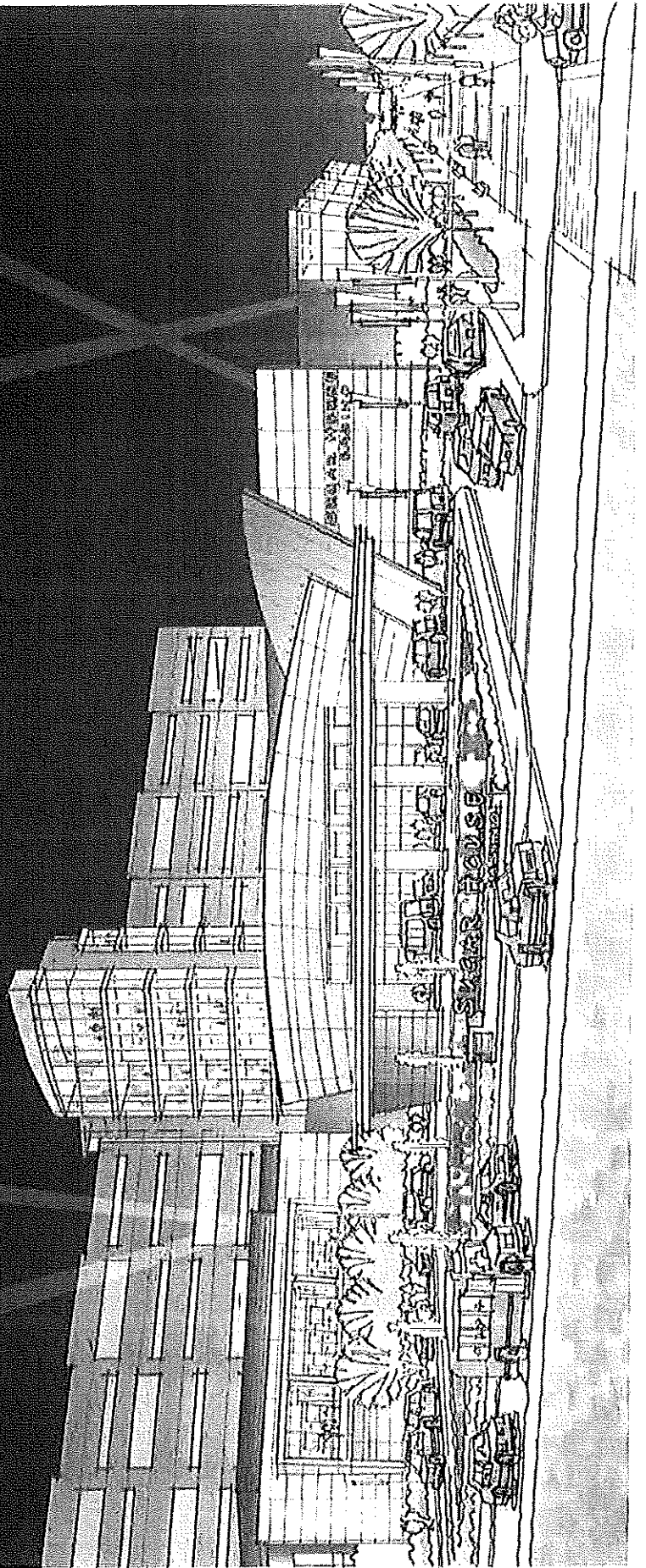

★ **Permits and Approvals Received to Date**

- **CITY**
 - **Approval of Plan of Development (May 2007 version)**
 - **Submerged Lands License (November 2007)**
 - **Zoning and Use Permit (January 2008)**
 - **Rough Grading Permit (January 2008)**
 - **Foundation Permit (March 2009)**
- **STATE**
 - **National Pollution Discharge Elimination System (NPDES) Permit (January 2007)**
 - **Chapter 105 Water Obstruction and Encroachment Permit (September 2008)**
 - **Sewage Facilities Act (Act 537) – Issued to City of Philadelphia (September 2008)**
- **FEDERAL**
 - **None to Date**

★ **Permits and Approvals Needed to Construct Interim / Phase I Facility**

CITY:

- Approval of Plan of Development (Amended)
- Submerged Lands License (Issued November 2007)
- Zoning and Use Permit (For Amended Plan of Development)
- Foundation Permit (March 2009)
- Building Permit
- Certificate of Occupancy
- City Council Ordinance #090351 Related to Off-Site Parking

STATE:

- National Pollution Discharge Elimination System (NPDES) Permit (January 2008 Permit Amended)
- Chapter 105 Water Obstruction and Encroachment Permit (September 2008 Permit Amended)
- Sewage Facilities Act (Act 537) – Issued to City of Philadelphia (September 2008)
- Highway Occupancy Permit (Pending)

FEDERAL: None Needed (No ACOE Permit Required)



SugarHouse

PURE FUN

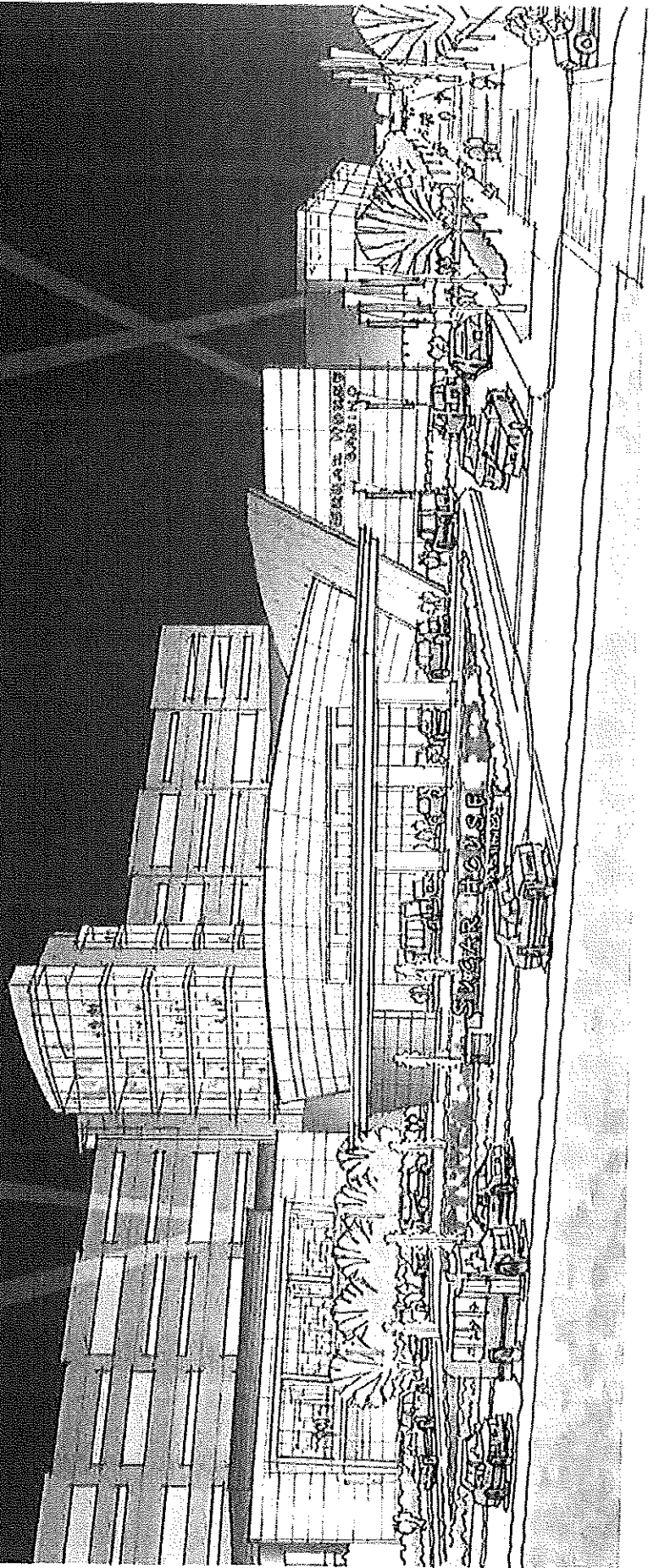

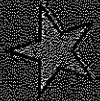

Interim Casino

Design/Approval Period: 4 months

Construction Period: 9 months

Anticipated Opening: 2nd Quarter 2010



SugarHouse
PURE FUN

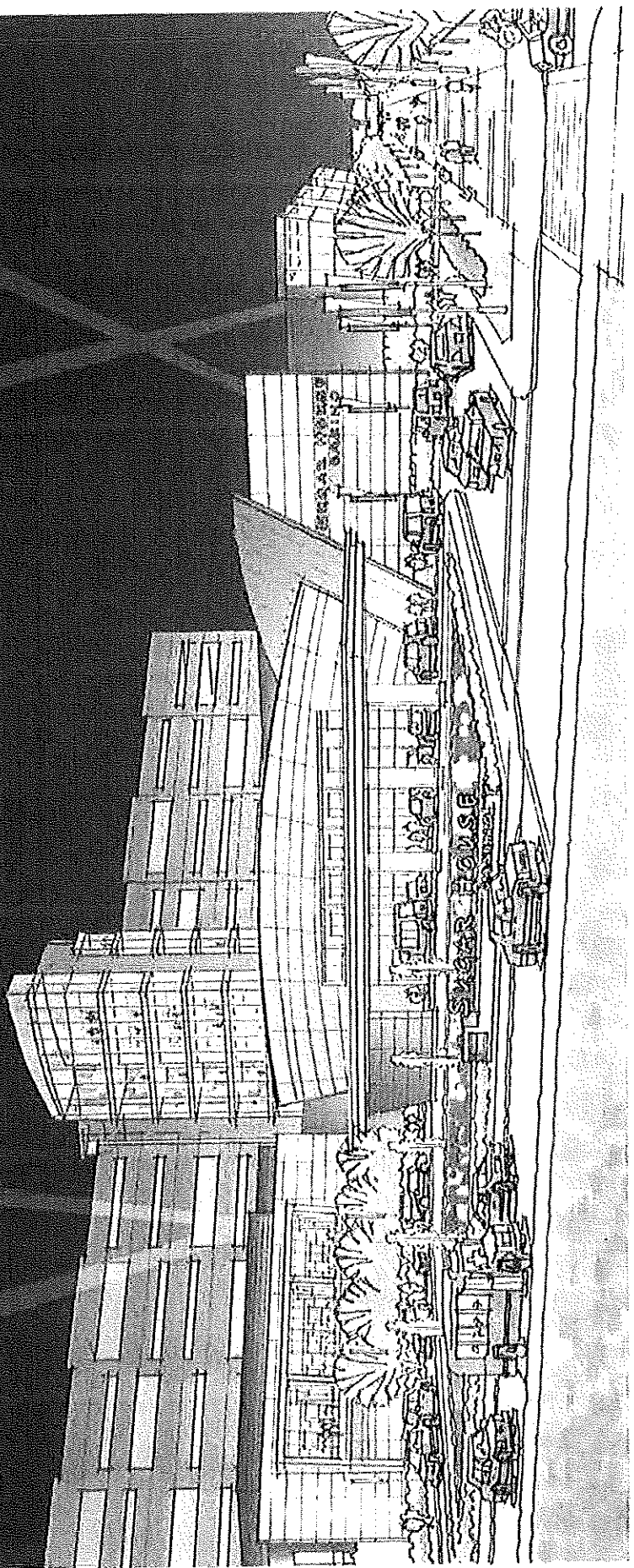

SugarHouse

— PURE FUN —

